



REIN & GROSSEHME
COMMERCIAL REAL ESTATE

THE PALMS CENTER

Just North of Greenway Rd. on 35th Ave.
15610/ 15620 N. 35th Avenue, Phoenix, AZ

FOR LEASE

900 SF Available

Lots of Parking

Monument Signage (Free)

1 Mile to I-17, 3 Miles
to Loop 101

Local, Accessible,
Friendly Owners



8767 E. Via de Ventura
Suite 290
Scottsdale, AZ 85258
RGcre.com

MARK REIN

Owner/Agent

480.214.9414

Mark@RGcre.com



REIN & GROSSEOHME
COMMERCIAL REAL ESTATE

FOR LEASE

900 SF Available

Lots of Parking

Monument Signage (Free)

1 Mile to I-17, 3 Miles
to Loop 101

Local, Accessible,
Friendly Owners

The information contained herein has been obtained from sources we believe to be reliable, however, Rein & Grosseohme and its agents have not conducted any investigation regarding these matters and make no warranty or representation expressed or implied regarding the accuracy or completeness of the information. Interested parties need to verify any information that is critical to their decision process and bear all risk for inaccuracies. References to square footage or age are approximate.

8767 E. Via de Ventura
Suite 290
Scottsdale, AZ 85258
RGcre.com

THE PALMS CENTER

Just North of Greenway Rd. on 35th Ave.
15610/ 15620 N. 35th Avenue, Phoenix, AZ



MARK REIN

Owner/Agent

480.214.9414

Mark@RGcre.com



REIN & GROSSEHME
COMMERCIAL REAL ESTATE

THE PALMS CENTER

Just North of Greenway Rd. on 35th Ave.
15610/ 15620 N. 35th Avenue, Phoenix, AZ

AVAILABLE SUITES

Building 15610

Suite 7: 900 SF
Open Floor Plan
with Tile Floor.
Available 06/01/2022.
\$10.00 NNN

The information contained herein has been obtained from sources we believe to be reliable, however, Rein & Grossehme and its agents have not conducted any investigation regarding these matters and make no warranty or representation expressed or implied regarding the accuracy or completeness of the information. Interested parties need to verify any information that is critical to their decision process and bear all risk for inaccuracies. References to square footage or age are approximate.

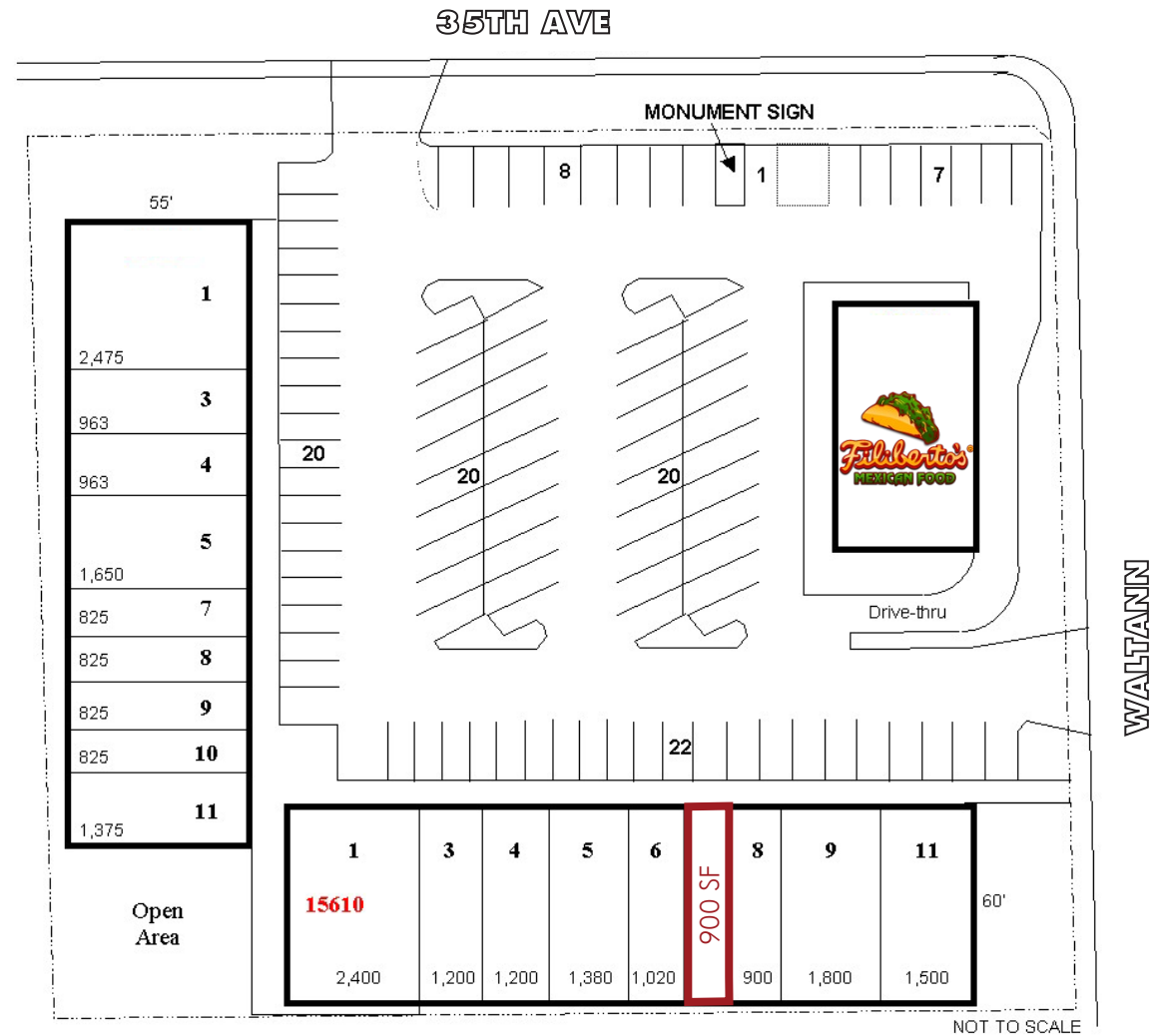

NOT TO SCALE



8767 E. Via de Ventura
Suite 290
Scottsdale, AZ 85258
RGcre.com

MARK REIN

Owner/Agent

480.214.9414

Mark@RGcre.com



THE PALMS CENTER

Just North of Greenway Rd. on 35th Ave.
15610/ 15620 N. 35th Avenue, Phoenix, AZ

FLOOR PLANS

Building 15610

Suite 7: 900 SF
Open Floor Plan
with Tile Floor.
Available 06/01/2022.
\$10.00 NNN

The information contained herein has been obtained from sources we believe to be reliable, however, Rein & Grossoehme and its agents have not conducted any investigation regarding these matters and make no warranty or representation expressed or implied regarding the accuracy or completeness of the information. Interested parties need to verify any information that is critical to their decision process and bear all risk for inaccuracies. References to square footage or age are approximate.



Approximately to scale
All dimensions are
approximate and to the
middle of the walls.

8767 E. Via de Ventura
Suite 290
Scottsdale, AZ 85258
RGcre.com

MARK REIN

Owner/Agent

480.214.9414

Mark@RGcre.com



REIN & GROSSEHME
COMMERCIAL REAL ESTATE

THE PALMS CENTER

Just North of Greenway Rd. on 35th Ave.
15610/ 15620 N. 35th Avenue, Phoenix, AZ

DEMOGRAPHICS

(2017)

Population Estimates

3 Mile 150,050

Average Household
Income

3 Mile \$63,250

TRAFFIC COUNT

(2017)

35th Ave & Greenway

North 25,896

South 31,769

East 26,672

West 29,083

The information contained herein has been obtained from sources we believe to be reliable, however, Rein & Grosseohme and its agents have not conducted any investigation regarding these matters and make no warranty or representation expressed or implied regarding the accuracy or completeness of the information. Interested parties need to verify any information that is critical to their decision process and bear all risk for inaccuracies. References to square footage or age are approximate.

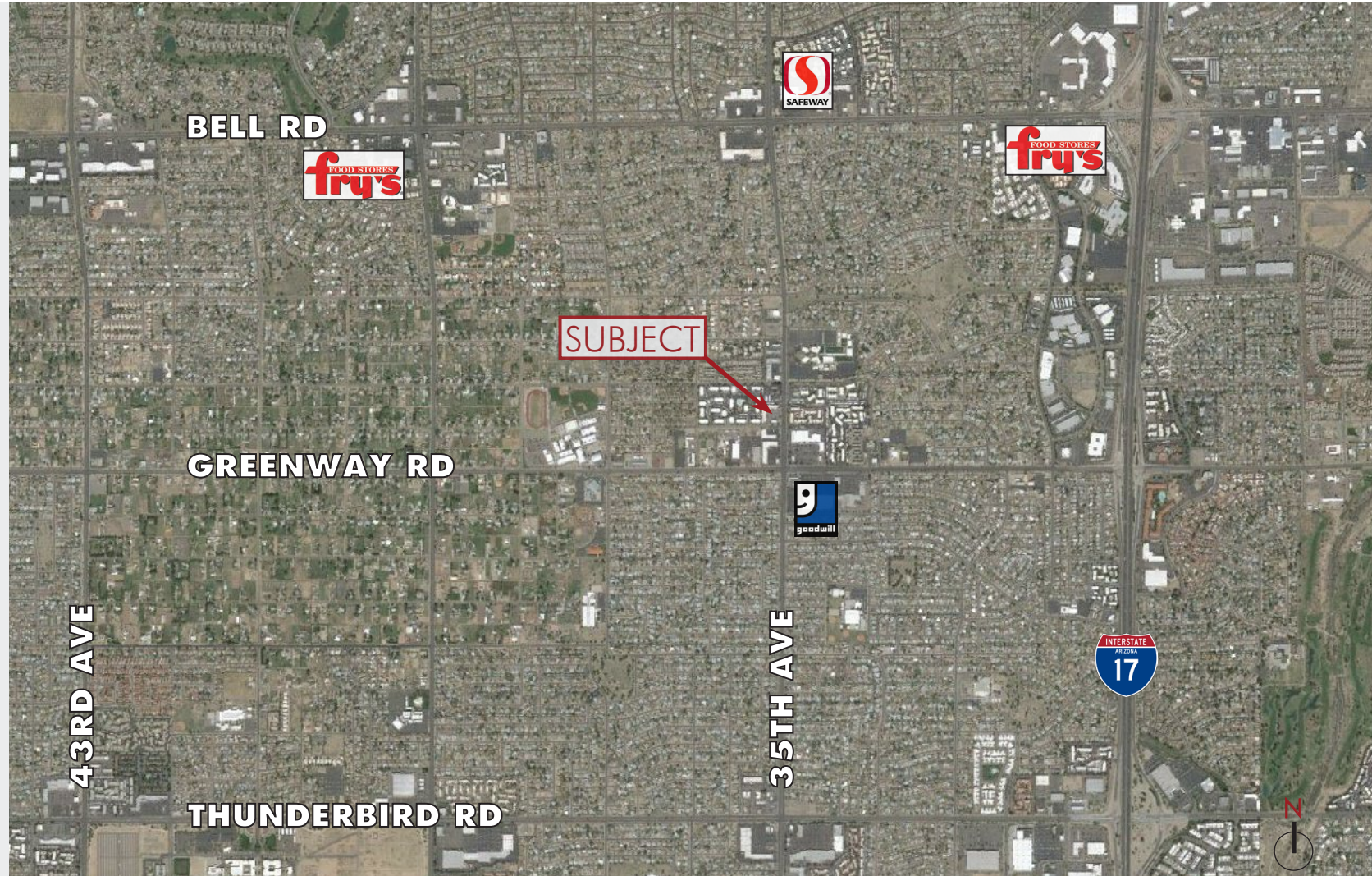

8767 E. Via de Ventura
Suite 290
Scottsdale, AZ 85258
RGcre.com

MARK REIN

Owner/Agent

480.214.9414

Mark@RGcre.com